



## MISS

Giuseppe Bavuso  
design

### Aluminium LED profile for recessed installation

**Materials:**

aluminium, polycarbonate, thermoplastic polymers

**Finishes:**

aluminium, black matt, brown, dark stainless

**Light source:**

SHE LED module (180 LED/m)

HE LED module (120 LED/m) - on request

**Wiring:**

2000mm

**Application type:**

under cabinet, under shelf

**Installation:**

recessed

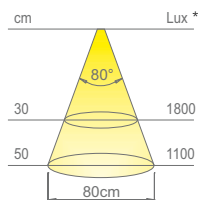
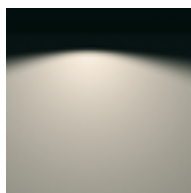

**Colour appearance** natural white  
**Colour temperature** 4100 K  
**Luminous efficiency** 85 lm/W  
**CRI** Ra ≥ 80

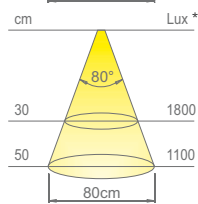
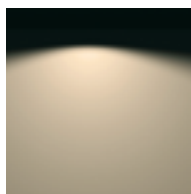

**Colour appearance** warm white  
**Colour temperature** 2900 K  
**Luminous efficiency** 85 lm/W  
**CRI** Ra ≥ 80

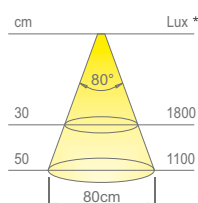
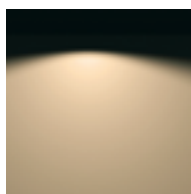

**Colour appearance** super warm white  
**Colour temperature** 2600 K  
**Luminous efficiency** 85 lm/W  
**CRI** Ra ≥ 80

\* values referring to MISS SHE 1130mm

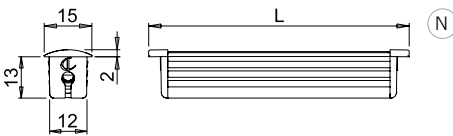
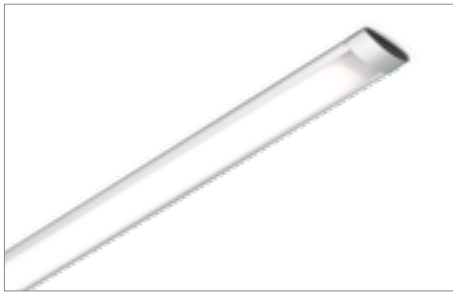

**MISS**



without sensor - for installation in a blind milled groove

Code	Model	Watt & Volt
on request*	SHE (180 LED/m)	14,4W/m @ 24Vdc

**CONVERTER NOT INCLUDED. TO BE ORDERED SEPARATELY.**

\* Codes will be provided according to the length requested.



This drawing shows the profile's overall dimensions. See installation manual for more details.

This profile integrates a stripled with OSRAM Opto Semiconductors diodes.

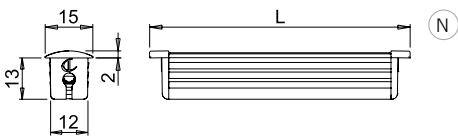

**MISS SD**



with electronic infrared dimmer switch - for installation in a blind milled groove

Code	Model	Watt & Volt
on request*	SHE (180 LED/m)	14,4W/m @ 24Vdc

**CONVERTER NOT INCLUDED. TO BE ORDERED SEPARATELY.**

\* Codes will be provided according to the length requested.



This drawing shows the profile's overall dimensions. See installation manual for more details.

This profile integrates a stripled with OSRAM Opto Semiconductors diodes.



**MISS SD** integrates an electronic infrared dimmer switch which allows to turning on, turning off and adjusting the light intensity of the profile.

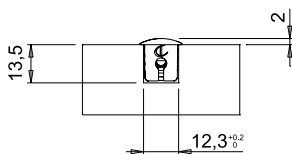

**MISS** is designed for recessed installation to a blind groove 12.3mm wide and 13.5mm deep.

**MISS** is designed for recessed installation to a blind groove 12.3mm wide and 13.5mm deep. Its length can be adapted to your needs, with a minimum of 300mm and a maximum of 3000mm. **MISS** is recommended for horizontal installation under kitchen cabinets, sideboards, bookshelves and cabinets.

**FINISHES**



**ALUMINIUM** (code 05)



**BLACK MATT** (code 32)



**BROWN** (code 39)



**DARK STAINLESS** (code 50)

MISS profile alone with relative accessories (screen and heads) for customisation also available. For details consult the **Flexyled collection catalogue** available also on [www.domusline.com](http://www.domusline.com)



For LED converters and accessories see page 76 or consult the **Domus Extra catalogue** also available on [www.domusline.com](http://www.domusline.com).



<sup>1</sup> For UL-certified model codes, see the **American standard LED collection catalogue**, also available at [www.domusline.com](http://www.domusline.com).

